



# H0/00 Track Cleaner

## Please read before operating unit

### OVERVIEW

The model does not need lubricating before use. The model operates using a maximum power of 9 volts. The model operates on normal DC power. For DCC operation please refer to the section 'DCC operation'. The model has 3 settings via the switch positioned on the top of the body. Please refer to diagram A. The model has an on-board motor which operates the cleaning functions. The motor does not provide any movement power and the model needs to be coupled to the locomotive of your choice for travelling the track.

The model is supplied with:

- (i) fine abrasive heads
- (ii) vacuum fan
- (iii) polishing heads
- (iv) foam pads for liquid
- (v) track brushes

Items (i) and (iii) are fitted and removed by simply pushing / pulling the item using light finger pressure. Both parts connect to the body via a small spindle which fits inside of the cavity in each model. Each item has a coiled spring which allows the heads to touch the track for the cleaning and polishing operations. Please ensure that the heads are loose and free-moving and not pushed solid inside of the body. Item (ii) is pushed into place with finger pressure but has to be removed by using the special tool. Please refer to diagrams B and C. Items (i) and (iii) comprise 3 separate parts (head + spring + shaft). The parts simply clip together. If during removal the shaft pulls away from the head, this is not a fault. It is a safety measure to ensure the metal spindle is not damaged. Simply push the parts together. Item (iv) is fitted with finger pressure and item (v) is changed by removing the visible screw.

### PROCESS of OPERATION

- 1: Fit and use the abrasive head (i). This removes dirt from the top of the rails
- 2: Fit and use the vacuum fan (ii). This removes dust from the track area and places it inside of the on-board 'bin'. To empty the dust, remove the loose mesh top cover and turn the whole track cleaning car upside down allowing any dust to fall away. -NOTE \* When fitting the vacuum fan the blades of the head are positioned INSIDE of the body.
- 3: Fit and use the polishing head (iii) and, for extra cleaning, place a small amount of proprietary track cleaning fluid inside of the on-board tank. Remember to apply the cap after filling. Please refer to diagram A. This process involves the cleaning fluid travelling into the foam pad (iv) via a pinhole in the tank and being applied to the rails immediately before the operation of the polishing head. The brass weight inside of the tank is to regulate the flow of liquid during the operation. Please remember that the brass weight is a loose part; be careful not to lose it. Finally the track brush adds extra cleaning for areas on the inside and outside of the rails.

Dapol recommend that the abrasive head is only used occasionally. The polishing head should be used as needed and depending upon the actual use and environmental conditions of the layout area. Spare heads are supplied with the model and additional packs are available from your local stockist.

### OPERATION

Fit the head of your choice. Position the switch to the 'OFF' setting and place the model onto the track. Couple it to your locomotive. Turn the switch to the 'ON' position. Apply power to your locomotive via your controller. The motor in the track cleaner will start to operate. As more power is applied to the track your locomotive will start to move and the motor of the track cleaner will spin faster. The power applied to the track will be split equally between the locomotive and the track cleaner. If there are areas of severe dirt on the track (perhaps inside of tunnels) then position the switch on the track cleaner to the 'CL-POWER' setting. This distributes extra power to the cleaning heads. However, please note this position should only be used for short periods. If the motor overspins there is a safety cut-out and the track cleaner motor will stop. If this happens please wait for 5 minutes and then return the switch to the normal 'ON' position. For the vacuum and polishing operations you should only use the 'ON' setting position.

### DCC OPERATION

The track cleaner is fitted with an on-board 8-pin PCB. For removal of the cover please refer to the various diagrams. The PCB is pre-fitted with a DC 'blanking' chip. This chip is removed by carefully pulling it away from the PCB. You can then fit the DCC 8-pin chip of your choice and program as needed. Please note that even with the DCC chip fitted you still have to position the model switch to the 'ON' position.

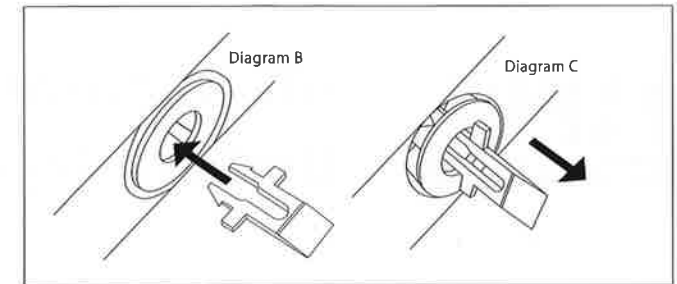
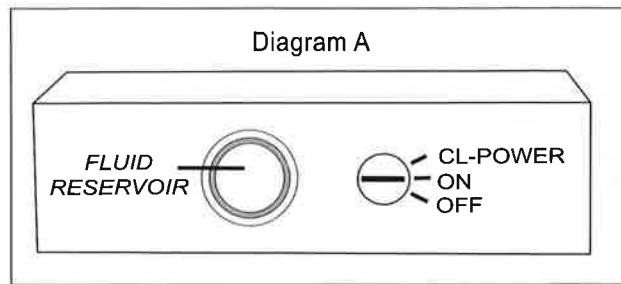

### DCC OPERATION : 1

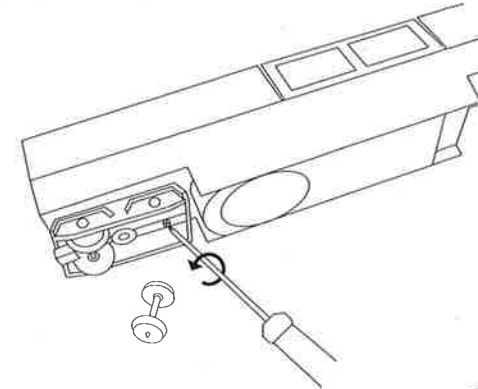

Remove axle from bogie. Unscrew cross-headed screw and remove bogie assembly from body

### DCC OPERATION : 2

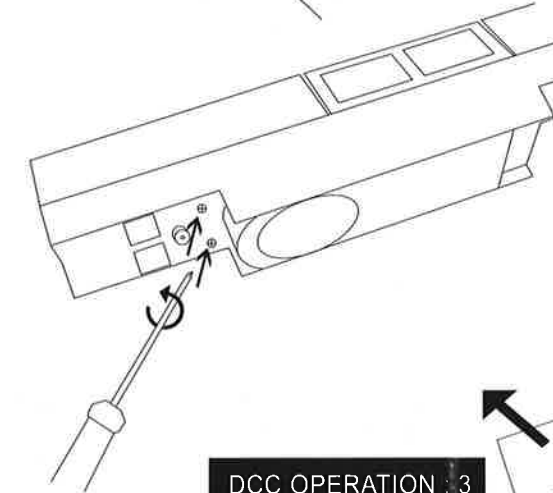

Unscrew 2 cross-headed screws to loosen top cover.

### DCC OPERATION : 3

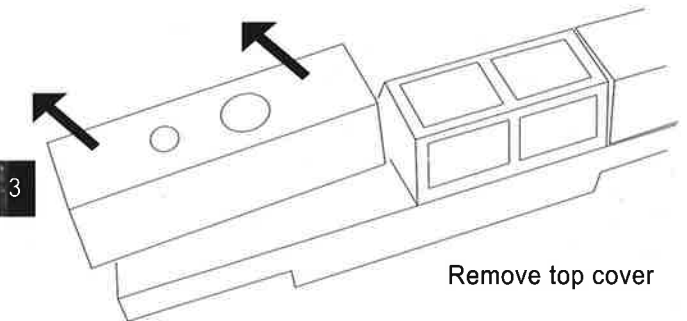

Remove top cover

### DCC OPERATION : 4

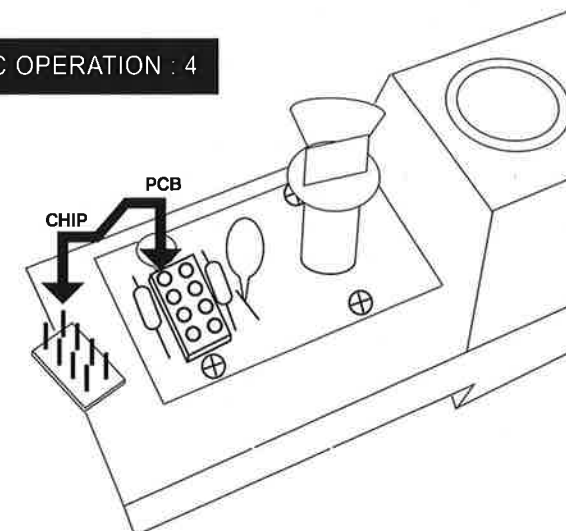

Remove DC Blanking Chip and fit the 8-pin chip of your choice

### DCC OPERATION : 5

Reverse above procedure to return Track Cleaner to operational use.