

ALP-45DP DUAL POWER LOCO H0 SCALE

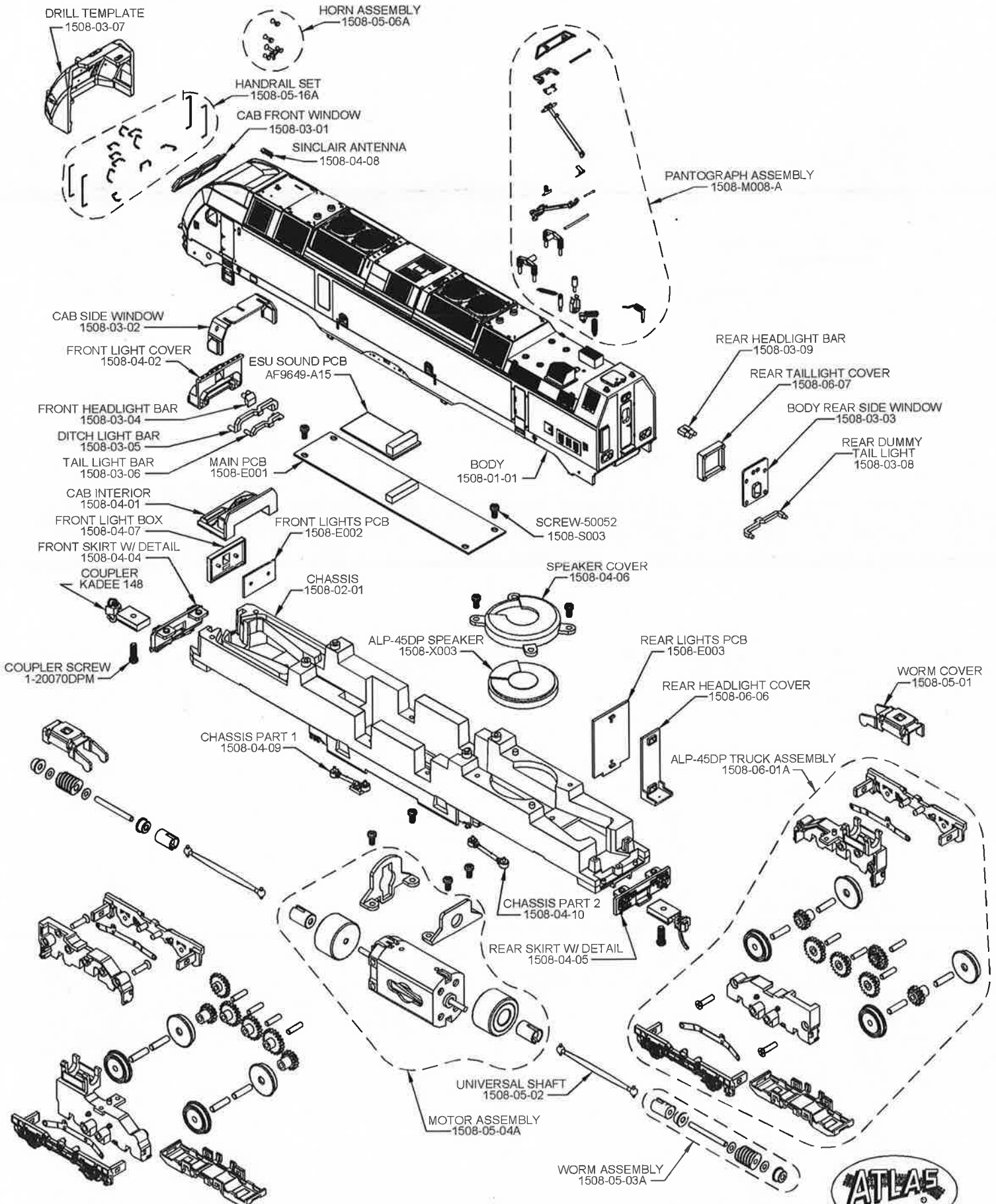

ATLAS ALP-45DP LOCOMOTIVE – INSTRUCTIONS FOR INSTALLATION OF OPTIONAL GRAB IRONS

1. To drill out the grab iron holes on the front of the locomotive, you will need the drill template, a pin-vise, and a number #.80 drill bit. The template has been pre-drilled, which will help guide the drill. Only drill in the direction of hole on the template.
2. It is recommended, but not required, that the body shell is removed from the chassis before proceeding. To do so, first remove the front and rear coupler pockets which are secured in place with a small screw. Then gently pull the bottom edges of the body away from the chassis near the center of the locomotive which will allow the two to separate easily.
3. Carefully place the drilling template over the front of the nose making sure the tab fits under the anti-climber, which will lock it into place.

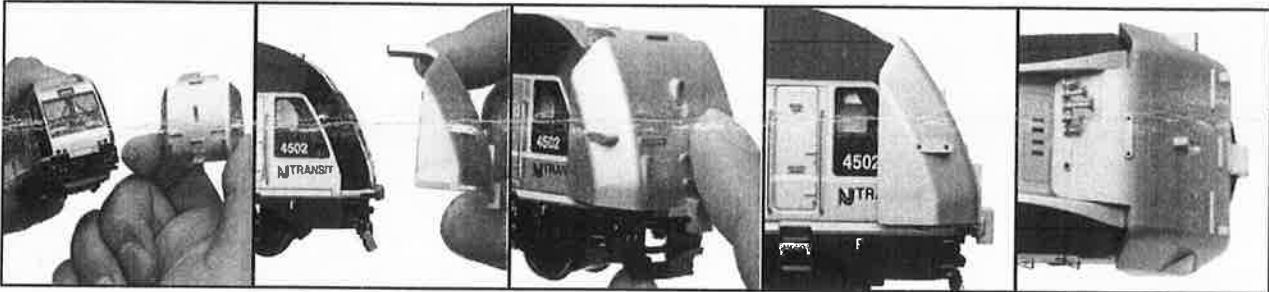

4. Using the template as a guide, carefully drill holes through the body.

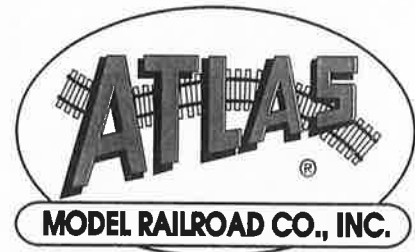
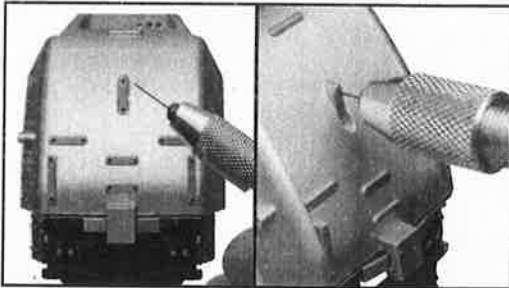

5. Each grab iron is numbered on the sprue. Using a sharp hobby knife or sprue cutter, detach each grab iron.
6. Using a tweezers, place the grab irons into each corresponding hole. (See photo diagram for grab iron placement)

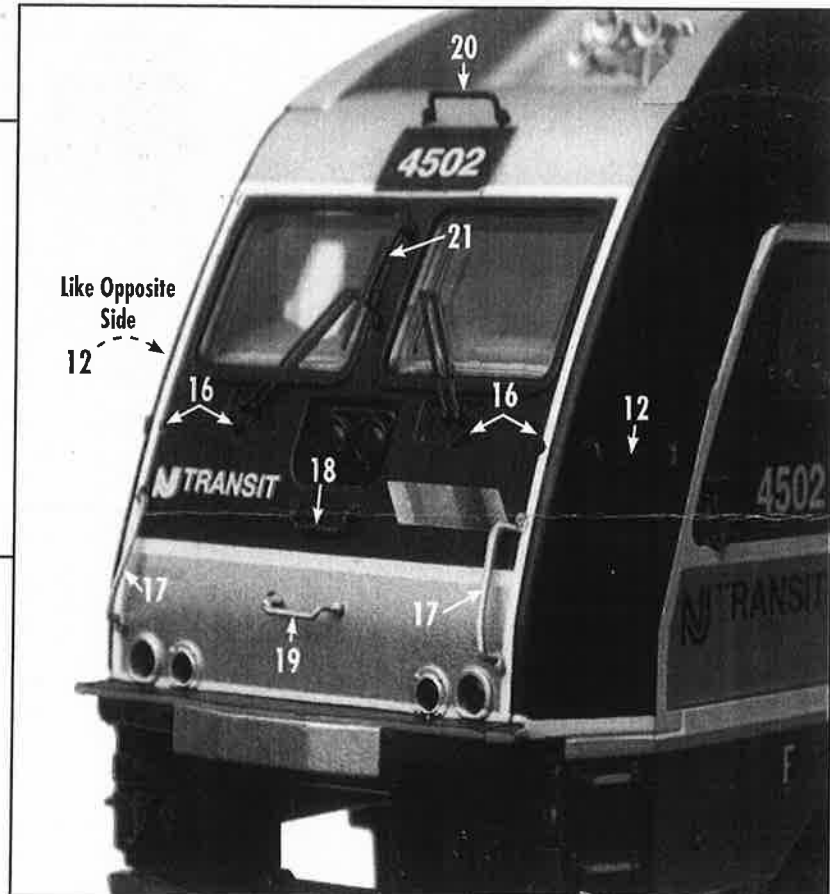

7. If you separated the body from the chassis in step 2, you can apply a small dab of super glue/hobby cement inside the body to ensure the grab irons will not become loose.
8. When finished, place the body shell back onto the chassis. The body is seated properly when the cab interior part aligns flush with the inner window detail part. The coupler boxes can then be reattached.